

## INSTRUCTION SHEET

STEP 1:

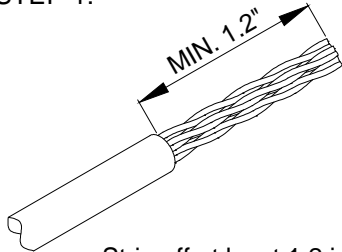

Strip off at least 1.2 inch of jacket from end of cable.

STEP 2:

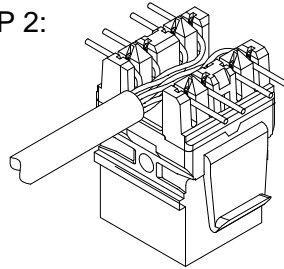

Press the wires through the projecting portion of terminals until fixed.

STEP 3:

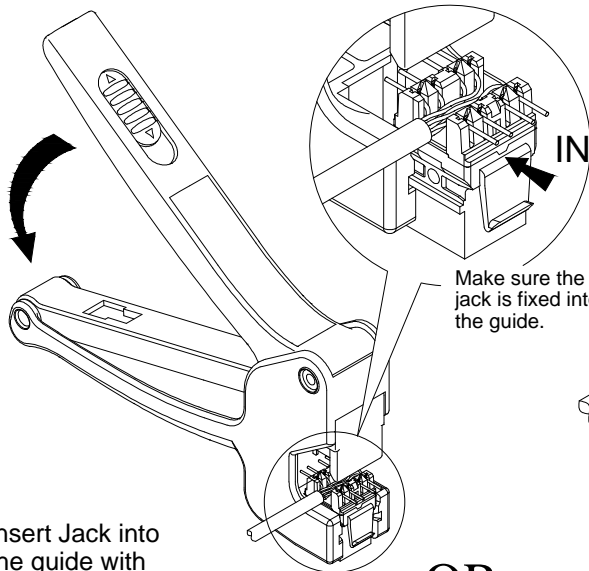

Insert Jack into the guide with either directions.

OR

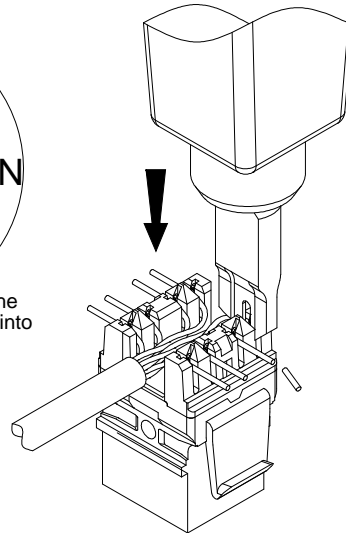

Terminate wires with punch down tool. Make sure the tool cuts off the excess wires.

STEP 4:

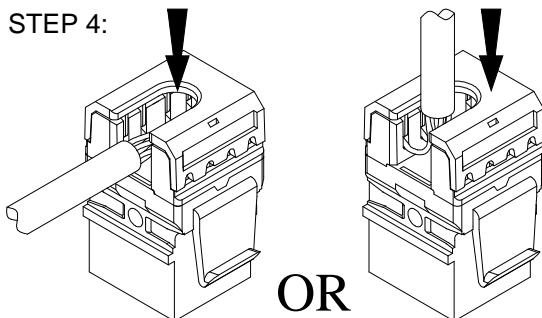

OR

Place cap on Jack and press to make sure it is fully seated. The cap opening allows the cable enters the jack from side or rear.